



EXPLODED VIEW PARTS AND PRICE LIST

MODEL 1377	1322
7-1377	7-1322

CROSMAN CORPORATION
RT 5 & 20
EAST BLOOMFIELD, NY 14443

Phone: 1-800-724-7486
Parts Order Fax: 585-657-5405

C1377EVP C1322EVP C7-1377EVP C7-1322EVP

MODEL NO.

1322C, 1377C

7-1322, 7-1377

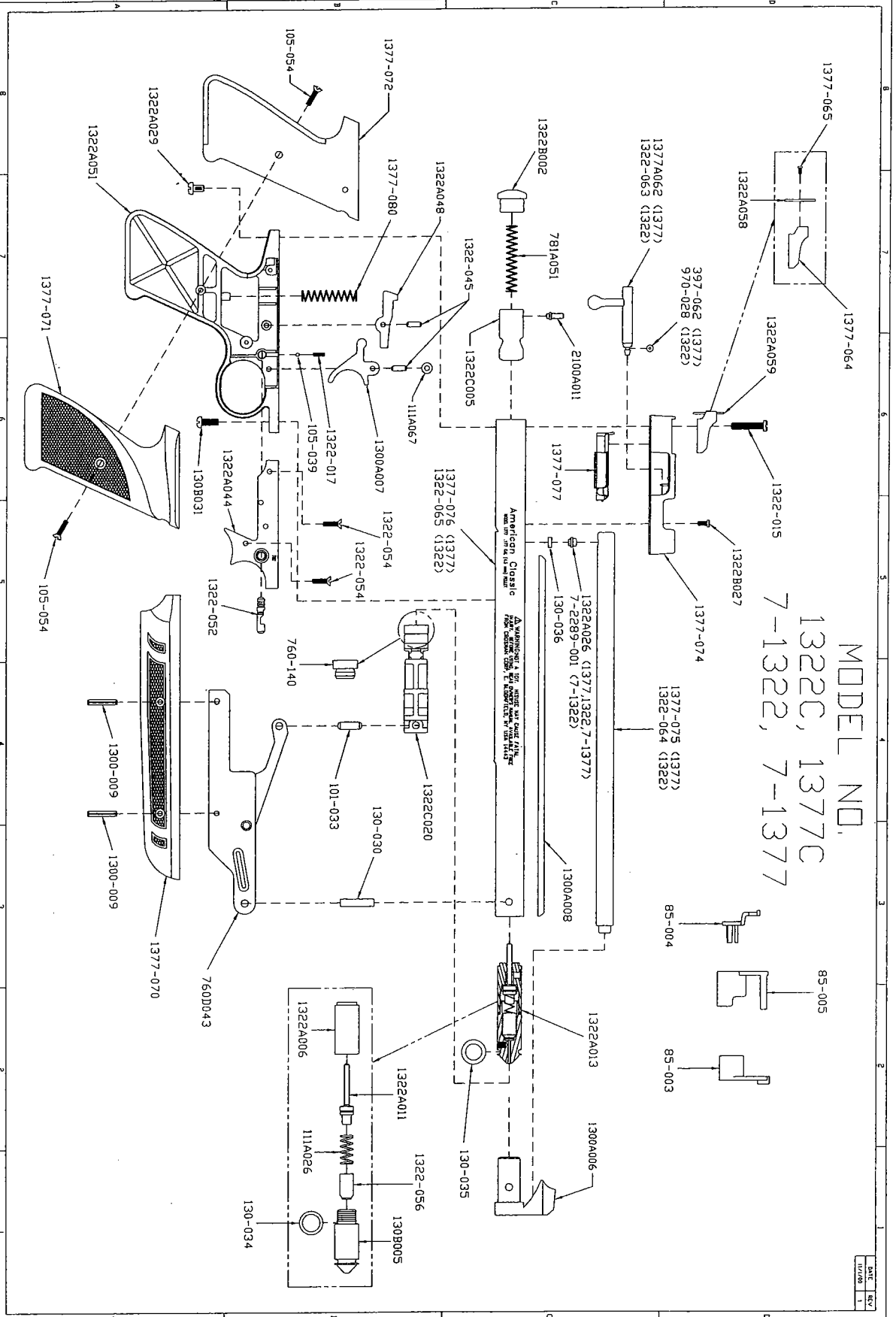

MODEL
1377 1322
PARTS AND PRICE LIST
BOLT ACTION

<u>PART NUMBER</u>	<u>QTY PER</u>	<u>PART NAME</u>	<u>COST</u>
101-033	1	PLUNGER GUIDE PIN	\$1.00
105-039	1	SAFETY BALL	\$1.00
105-054	2	GRIP SCREW	\$1.00 each
111A026	1	CHECK VALVE SPRING	\$1.00 use with 1322A013
760-146	1	CHECK VALVE SPRING	\$1.00 use with 1322B013
1300-009	2	PUMP GRIP PIN	\$1.00 each
130-030	1	PIVOT PIN	\$1.00
130-034	1	O-RING	\$1.00
130-035	1	O-RING	\$1.00
130-036	1	BREECH GASKET	\$1.00
1300A006	1	FRONT SIGHT	\$1.00
1300A007	1	TRIGGER	\$1.28
1300A008	1	BARREL MOLDING	\$1.00
130B005	1	CHECK VALVE BODY	\$1.08 use with 1322A013
130C005	1	CHECK VALVE BODY	\$1.08 use with 1322B013
130B031	1	FRONT FRAME SCREW	\$1.00
1322A006	1	EXHAUST VALVE BODY	\$1.07
1322A013	1	VALVE ASS'Y (use 1322B013)	*
1322B013	1	VALVE ASS'Y with molded Stem Assy	\$3.54 Start February 2002
1322-015	1	REAR BREECH SCREW	\$1.00
1322-017	1	SAFETY SPRING	\$1.00
1322-045	2	TRIGGER PIN	\$1.00 each
1322-052	1	SAFETY	\$1.00
1322-054	2	COVER SCREW	\$1.00 each
1322-056	1	CHECK VALVE	\$1.00 use with 1322A013
760-147	1	CHECK VALVE	\$1.00 use with 1322B013
1322-063	1	BOLT ASS'Y	\$2.99
1322-064	1	.22 CAL BARREL	\$6.02
1322-065	1	PUMP TUBE	\$5.10
1322A011	1	VALVE STEM ASSY	\$1.00 use with 1322A013
760-140	1	VALVE STEM ASSY	\$1.00 use with 1322B013
1322A026	1	SLEEVE	\$1.00
1322A029	1	REAR FRAME SCREW	\$1.00
1322A044	1	COVER	\$2.96
1322A051	1	FRAME	\$6.43
1322A058	1	SIGHT BLADE	\$1.00
1322A059	1	REAR SIGHT ASS'Y	\$1.01
1322B002	1	TUBE PLUG	\$1.81
1322B027	1	BREECH SCREW	\$1.00
1322C020	1	PUMP ROD ASS'Y	\$1.00
1377-064	1	REAR SIGHT	\$1.00
1377-065	1	SIGHT BLADE SCREW	\$1.00
1377-070	1	FOREARM	\$1.61
1377-071	1	R.H. GRIP	\$1.06
1377-072	1	L.H. GRIP	\$1.06
1377-074	1	BREECH	\$1.21

PRICES ARE IN U.S.DOLLARS

MODEL
1377 1322
PARTS AND PRICE LIST
BOLT ACTION

<u>PART NUMBER</u>	<u>QTY PER</u>	<u>PART NAME</u>	<u>COST</u>
1377-075	1	.177 CAL BARREL	\$4.90
1377-076	1	PUMP TUBE	\$5.10
1377-077	1	BASE	\$1.00
1377-080	1	SEAR SPRING	\$1.00
1377A062	1	.177 CAL BOLT ASS'Y	\$2.97
2100-011	1	HAMMER PIN	\$1.00
397-062	1	.177 BREECH SEAL	\$1.00
760-140	1	PISTON	\$1.00
760D043	1	LEVER LINK ASS'Y	\$3.36
781A051	1	HAMMER SPRING	\$1.00
970-028	1	.22 BREECH SEAL	\$1.00

THIS PARTS AND PRICE LIST IS INTENDED TO BE AN INFORMATIONAL GUIDE IN ORDERING CROSMAN PARTS. IT IS NOT INSTRUCTIONAL MATERIAL AN WE THEREFORE ASSUME NO RESPONSIBILITY FOR THOSE WHO USE SAME WITHOUT PROPER FACTORY TRAINING.

PRICES AND PARTS ARE SUBJECT TO CHANGE WITHOUT NOTICE

PLEASE ORDER BY PART NUMBER AND DESCRIPTION

CHECK OR MONEY ORDER FOR THE TOTAL PRICE MUST ACCOMPANY THE ORDER

*** NOT AVAILABLE**

UPADATED 5/02

PRICES ARE IN U.S.DOLLARS